

Hi/Lo Corner Bracket®

Minimize light Gap

Until now, wall-mounted roller-shades have left an unmanaged “light gap” where two walls meet at 90° angles. MechoSystems’ Hi/Lo Corner Bracket offers a practical solution for these pesky, large light gaps. By utilizing a higher pocket for one of the two shades, the Hi/Lo Corner Bracket will minimize the light gap.

The Hi/Lo Corner Bracket:

- Minimizes the light gap common to curtainwall corners.
- Offers continuity of shading—even at right angles.
- Features a higher pocket that need only be one window-bay-wide to accomplish tight, corner-window coverage. The rest of the shade bands are installed at the lower pocket level.
- Idle-End brackets are recommended in the corner.

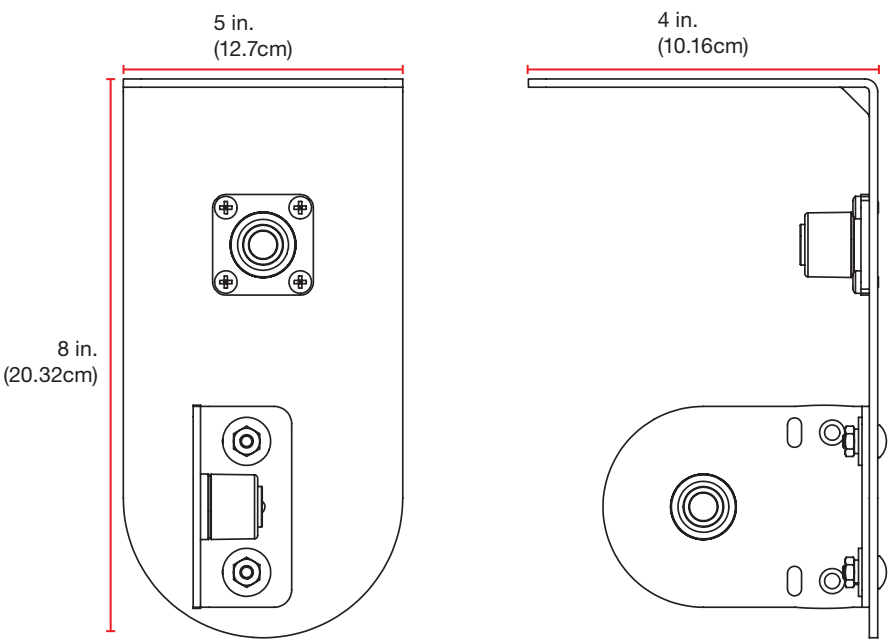

Hi/Lo Corner Bracket

Shadecloth options	Max. height (2.2 in. 5.5cm tube)	Max. height (2.5 in. 6.5cm tube)	Max. R.U.D. (roll-up diameter)
0200 Blackout	31½ ft. (9.6m)	25 ft. (7.6m)	3.56 in. (9.04cm)
0700 Blackout	33½ ft. (10.2m)	27 ft. (8.2m)	3.56 in. (9.04cm)
1300 Series	16½ ft. (5.02m)	13 ft. (4m)	3.56 in. (9.04cm)
6000 Series	20 ft. (6.1m)	16 ft. (4.9m)	3.56 in. (9.04cm)



Hi/Lo Corner Bracket®

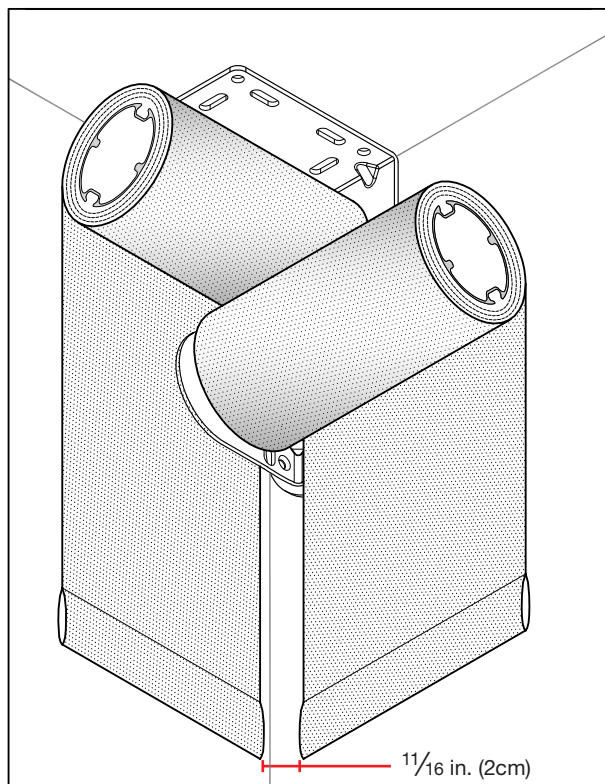

Inside corner — regular roll

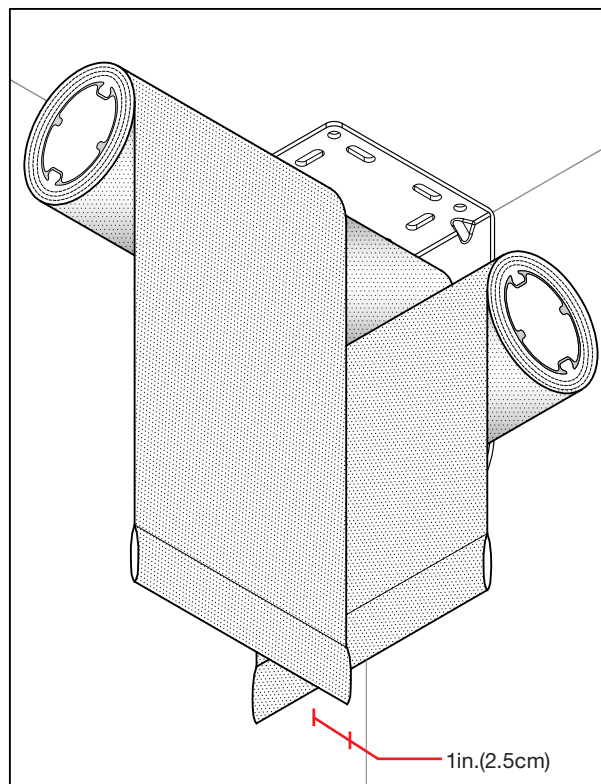

Inside corner — reverse roll

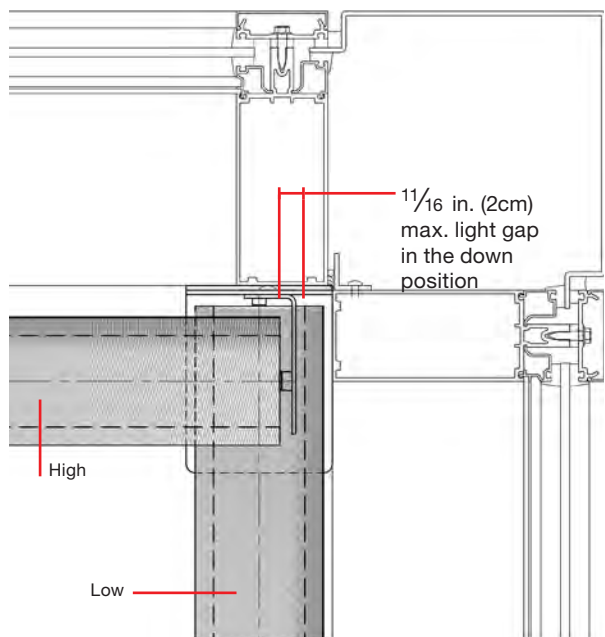

Inside corner — regular roll

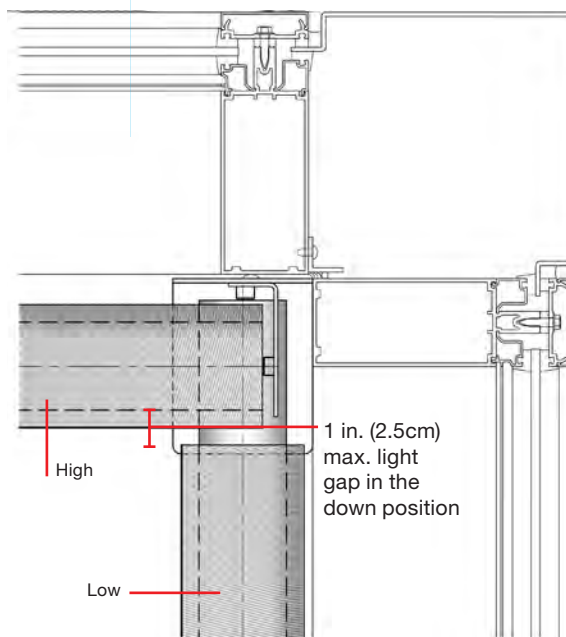

Inside corner — reverse roll



MechoSystems
Corporate Headquarters
42-03 35th Street
Long Island City, NY 11101

T: +1 (718) 729-2020
F: +1 (718) 729-2941
E: info@mechosystems.com
W: mechosystems.com